



PRODUCTS
FOR THE

AUTOMOTIVE INDUSTRY

APPLICATION GUIDE

NEXEN SOLUTIONS FOR YOUR AUTOMOTIVE INDUSTRY CHALLENGES

Over the years industry has come to recognize Nexen's Air Champ® line of pneumatic clutches and brakes for durability and reliability at economical prices. Our spring and air-engaged products provide more torque and last longer than comparable electrically-engaged units, we guarantee it. In addition to a wide range of motion control products, Nexen also offers custom engineering services for applications with special needs.

Decline Safety Conveyor

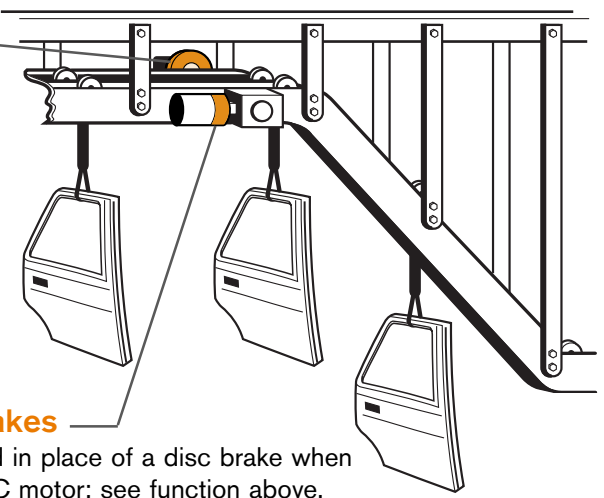

Caliper Disc Brake

Function: The spring-engaged brake holds the load and controls deceleration as well as providing dependable e-stops in power-off situations.

C-Faced Brakes

Function: Used in place of a disc brake when driven by an AC motor; see function above.

Bulk Handling Elevator

A standby drive eliminates downtime in the event of a motor failure by having two drive systems for each machine.

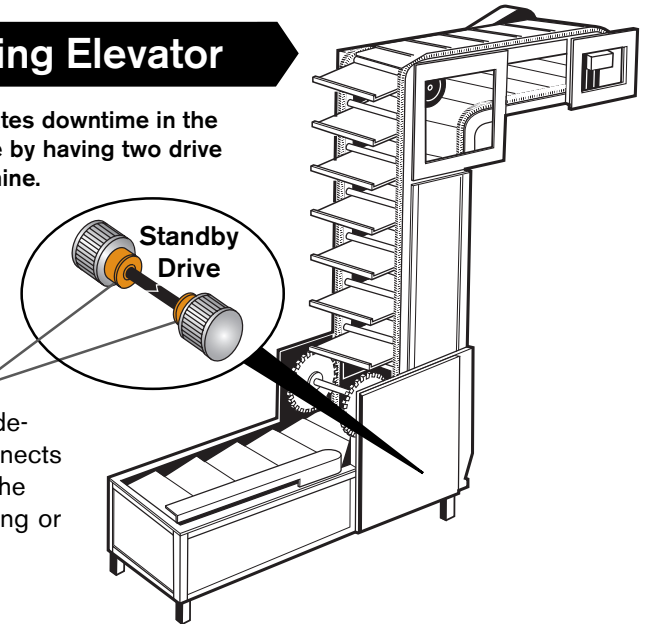

Tooth Clutches

Function: With repetitive dependability, the clutch connects and disconnects to allow the machine to pause for loading or unloading while the motor continues to run.

Articulating Balancing Arm

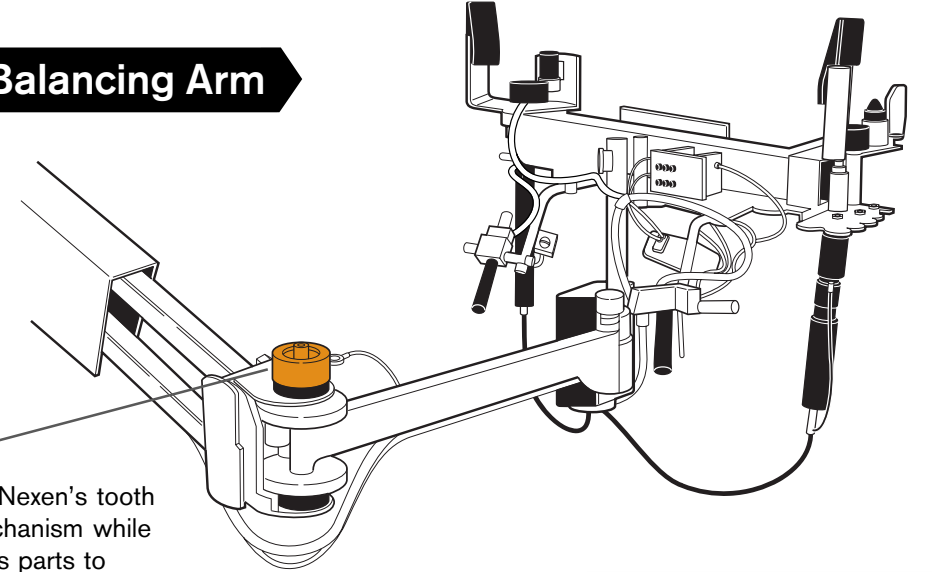

Tooth Clutch

Function: With fast engagement, Nexen's tooth clutches serve as the holding mechanism while the arm picks up, moves, or rotates parts to complete an operation.

Lift Table

AC Motor Brake

Function: Flange mounted and spring set, this brake provides quick stopping in emergency situations.

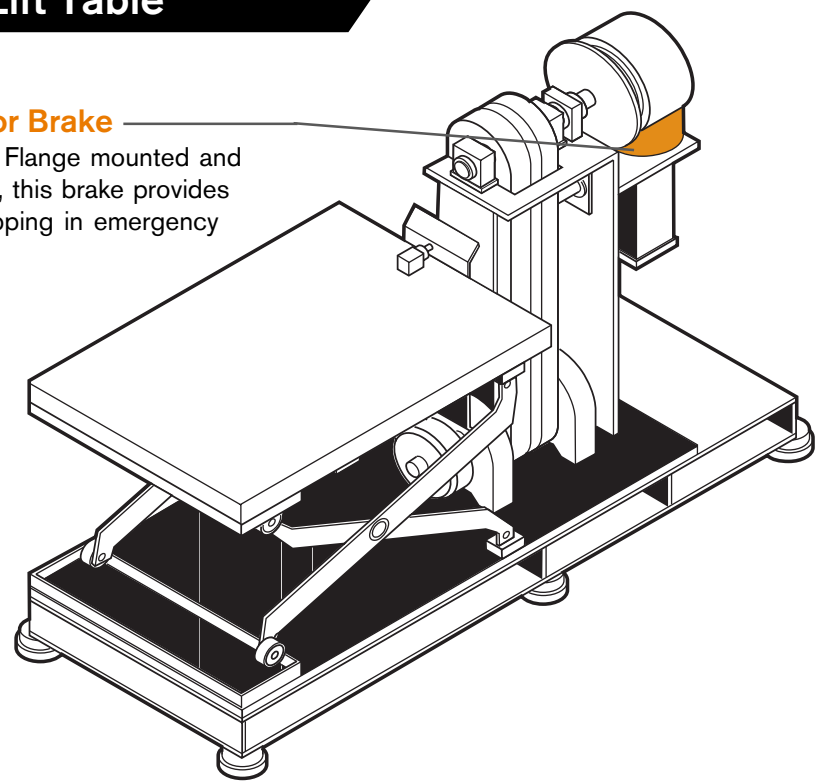

Tooth Clutches

Nexen's tooth clutches provide fast nonslip engagement for applications where high torque is needed. Inexpensive to operate, maintain and repair, these clutches provide all the torque you need in a small package.

- Torque range: 2–6214 Nm [20–55,000 in-lb]
- Fits shaft diameters from 16–78 mm [$\frac{5}{8}$ – $3\frac{1}{16}$ in]
- Positive no-slip engagement
- Single and multi-position models
- Pilot mount (sprocket mounting)
- Air-engaged / Spring-released units
- Available in standard open designs or as a totally enclosed unit



5HP Series



5H30S Model



5HP-Enclosed

Caliper Brakes

Nexen's caliper brakes are ideal for holding, e-stop, and controlled deceleration situations. Choose from ten standard models, or we will custom design to fit your application.

- Torque range: 2–6214 Nm [20–55,000 in-lb]
- Air-engaged / Spring-released units
- Spring-engaged / Air-released units
- Disc diameters from 152–609 mm [6–24 in]
- Adjustable caliper spacing for various disc widths
- Detent pins for quick facing shoe removal
- Simple design, easy to maintain



BD Hydraulic

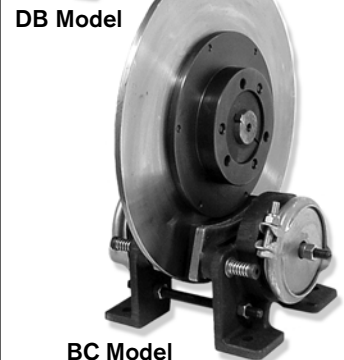

BC Model

Spring-Engaged Brakes

Designed for use in e-stop, controlled deceleration, and holding applications, Nexen's spring-engaged brakes have a high dynamic torque capacity that ensures a fast load response time. When dealing with expensive equipment and heavy products, reliability is key. These rugged brakes protect both the plant machinery and the operator by providing positive holding of the load throughout each process.



TSE Model

Servomotor Brake



Modular Unit

- Torque range: 2–6214 Nm [20–55,000 in-lb]
- Straight and tapered-bore shaft mounting
- Flange-mounted units
- Wide range of bore sizes
- NEMA C-face mounting
- Servomotor and motor brakes available
- Spring-engaged / Air-released brakes
- Few moving parts ensure dependability and durability with little maintenance needed
- Enclosed units for dirty, dusty or wet environments

Spring-Engaged Brakes

Air vs. Electric

Seven reasons why Nexen's air-engaged clutches and brakes are better than electric clutches and brakes.

- 1 > 30% Faster Response Time
- 2 > 40% More Dynamic Torque
- 3 > 30% More Thermal Horsepower
- 4 > Up to Six Times Longer Friction Facing Life
- 5 > Up to 60% Less Energy Consumption
- 6 > Up to 10% Savings on Unit Cost
- 7 > Up to 80% Savings in Repair Costs

nexen[®]

www.nexengroup.com

Headquarters

Nexen Group, Inc.
560 Oak Grove Parkway
Vadnais Heights, MN 55127-8509
Phone: 1-800-843-7445
or 651-484-5900
Fax: 651-286-1099

Nexen has worldwide offices in Europe, Asia, Australia, and Mexico. For the Nexen office nearest you, please consult the website listed above.



MEX (55) 53 63 23 31 MTY (81) 83 54 10 18
QRO (442) 1 95 72 60 ventas@industrialmagza.com

© Nexen Group, Inc. 2001
ISO 9001 Certified

21148-A-0802